



PAYDIRT

EARTHWORKS SUPPORT SERVICES

Takeoff Samples

Attached below are samples of what will be provided for takeoff requests. Each take off report will show views of the area, grading takeoffs will show 3D existing, proposed, and subgrade views, a cut fill map, and reports for cut fill, stripping/demo, subgrade cut fill, and subgrade materials reports. All pipe takeoffs will be accompanied with a PDF spreadsheet that will show type of pipe, pipe diameter, lengths of pipe, elevations of rims and inverts, backfill, bedding, if it is under pavement or not under pavement, and a marked up overview of the project. All erosion control and demo takeoffs will show the quantities of work areas along with a marked up overview of the project. Please see below for examples:



PAYDIRT

EARTHWORKS SUPPORT SERVICES

Takeoff - Grading Examples

Existing 3D View

This illustrates a view of the project as it sits prior to any excavation.



Paydirt Earthworks Support Services
contact@paydirtestimating.com
843-900-1002
170 Meeting Street
Charleston, SC 29401



PAYDIRT

EARTHWORKS SUPPORT SERVICES

Proposed 3D View

This illustrates the project after cut or fills have been made from the proposed contour lines.

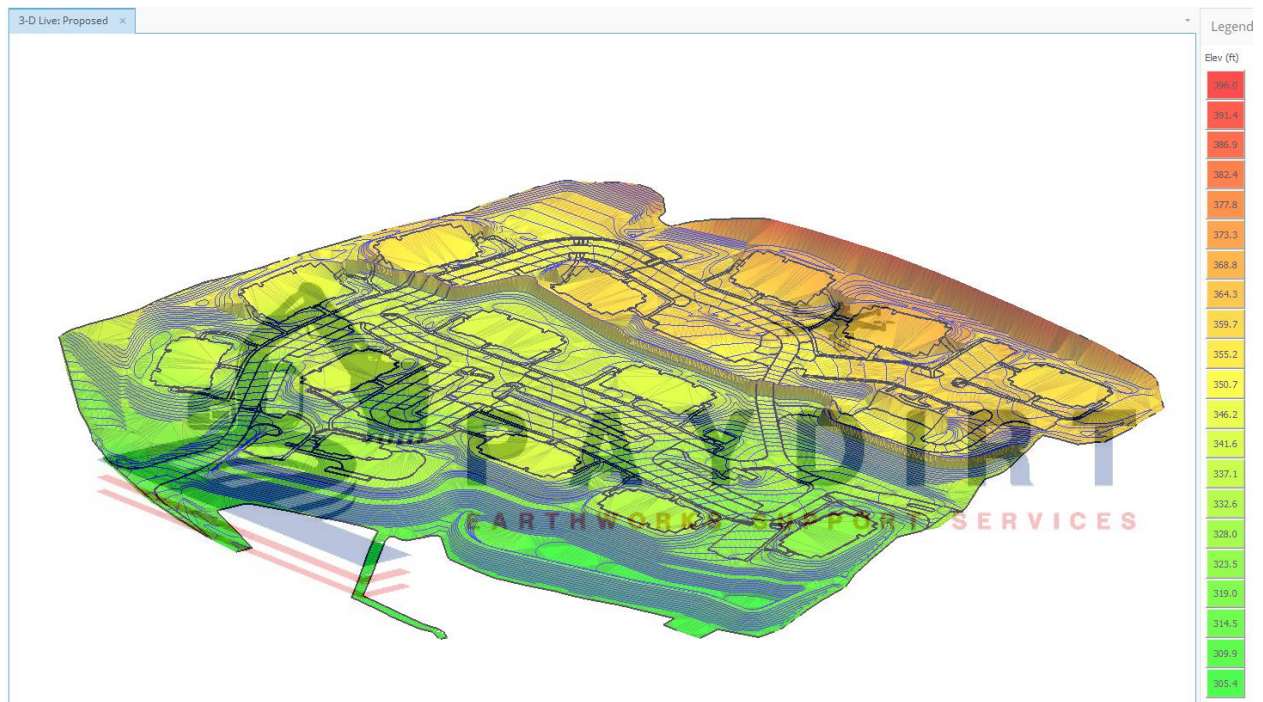

Paydirt Earthworks Support Services
contact@paydirtestimating.com
843-900-1002
170 Meeting Street
Charleston, SC 29401



PAYDIRT

EARTHWORKS SUPPORT SERVICES

Subgrade 3D View

This illustrates a view of the project after subgrade cuts and fills prior to any pavement being put down.

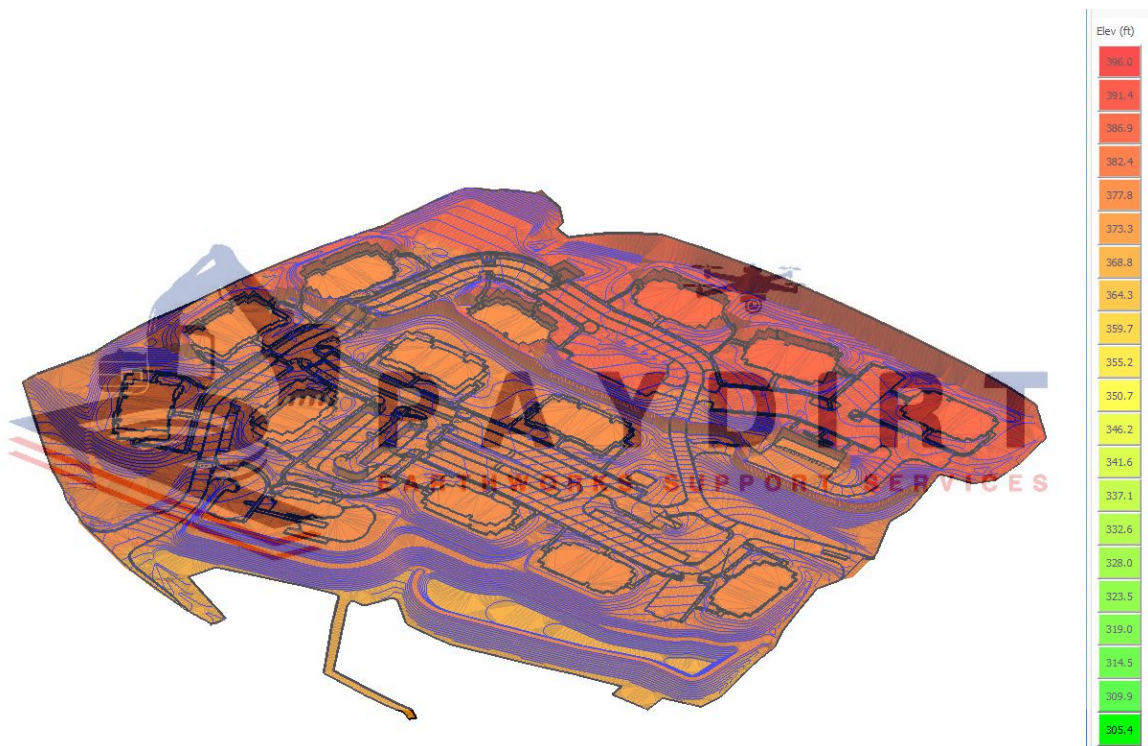

Paydirt Earthworks Support Services
contact@paydirtestimating.com
843-900-1002
170 Meeting Street
Charleston, SC 29401



PAYDIRT

EARTHWORKS SUPPORT SERVICES

Cut Fill Map

This shows where cuts and fills will be made. This can be shown as detailed as every 4" interval of cut and fill.

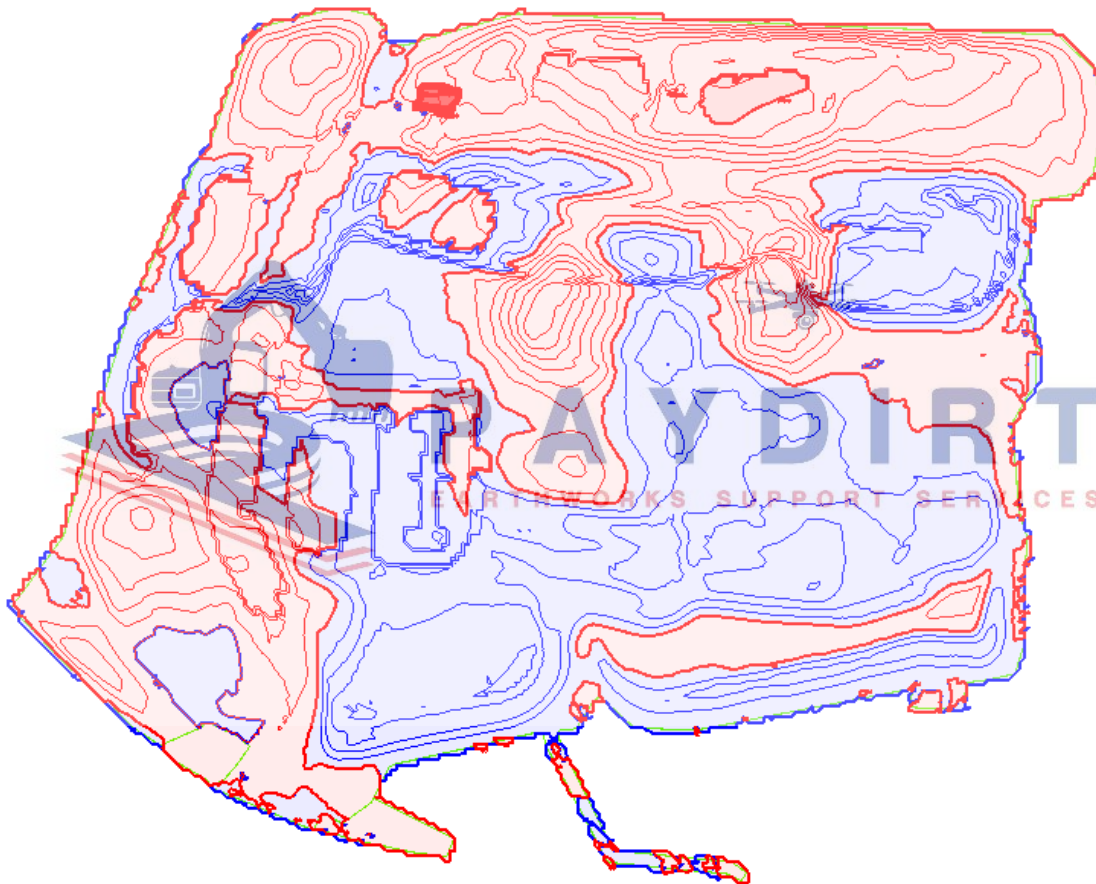

Paydirt Earthworks Support Services
contact@paydirtestimating.com
843-900-1002
170 Meeting Street
Charleston, SC 29401



PAYDIRT

EARTHWORKS SUPPORT SERVICES

Subgrade View

This illustrates where certain subgrades are located (pavements, foundations, topsoil, specialty material areas). This is color coded to the subgrade cut fill and subgrade materials reports.

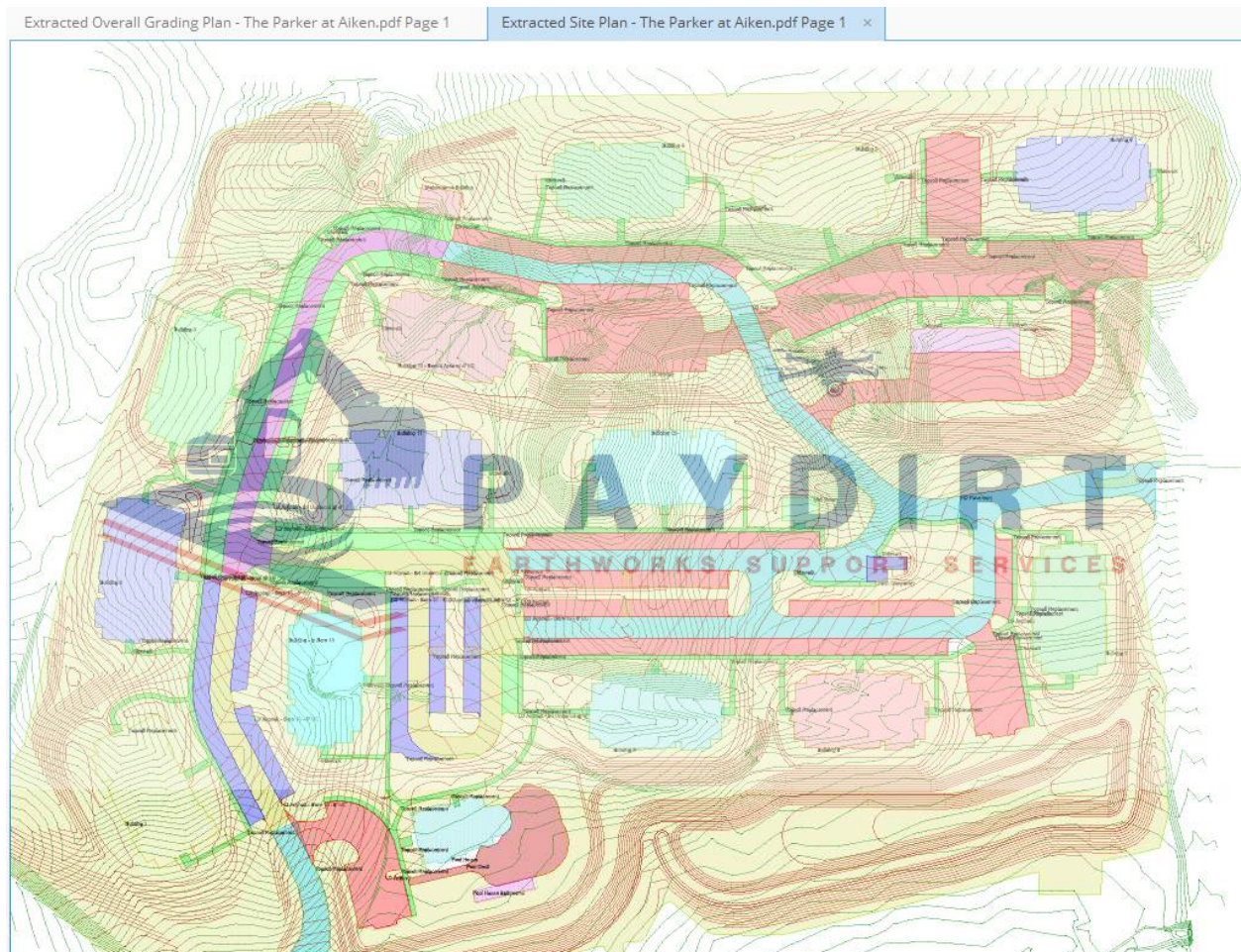

Paydirt Earthworks Support Services
contact@paydirtestimating.com
843-900-1002
170 Meeting Street
Charleston, SC 29401



PAYDIRT

EARTHWORKS SUPPORT SERVICES

Strip/Demo View

This illustrates the areas of demolition work areas. This is color coded to the strip/demo report.

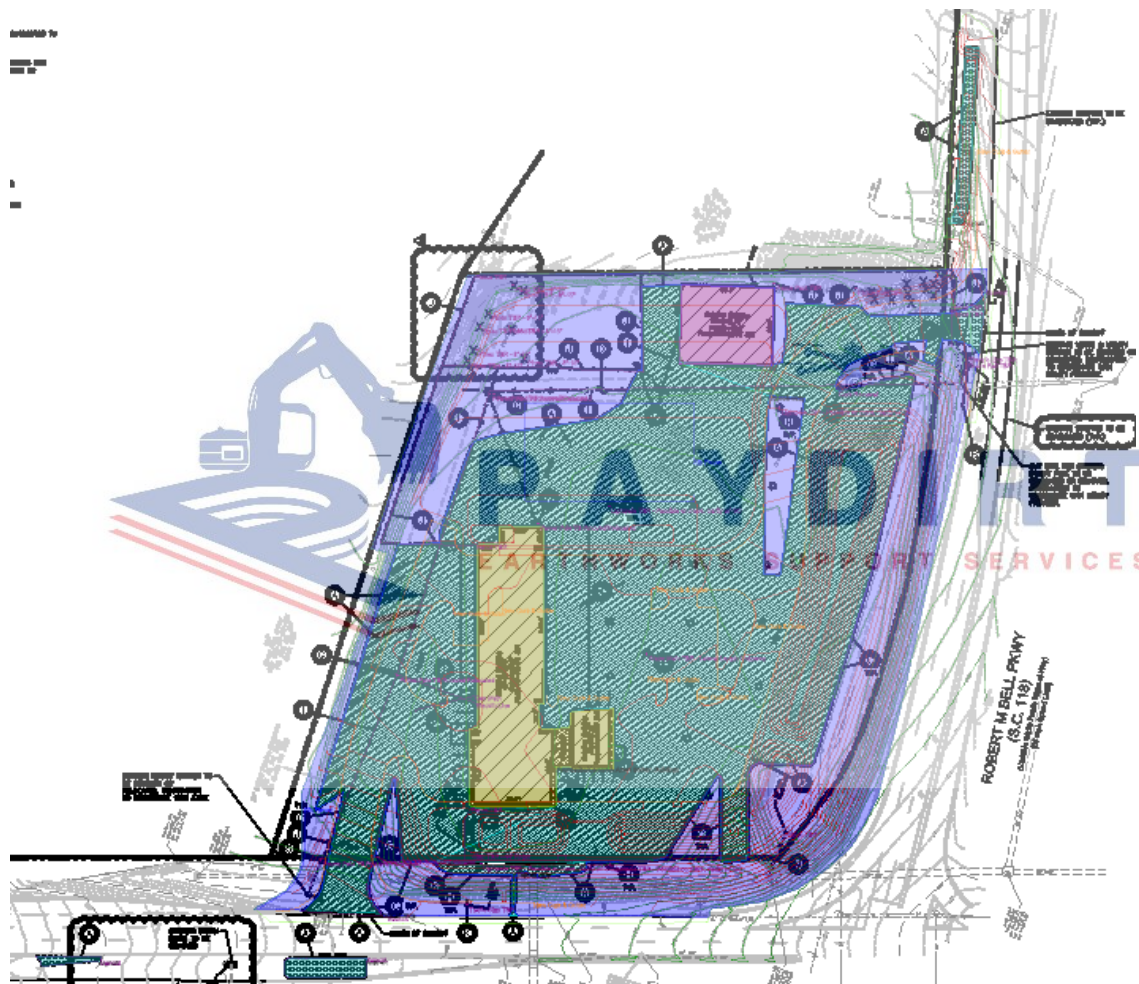

Paydirt Earthworks Support Services
contact@paydirtestimating.com
843-900-1002
170 Meeting Street
Charleston, SC 29401



PAYDIRT

EARTHWORKS SUPPORT SERVICES

Pipe and Erosion Control Samples

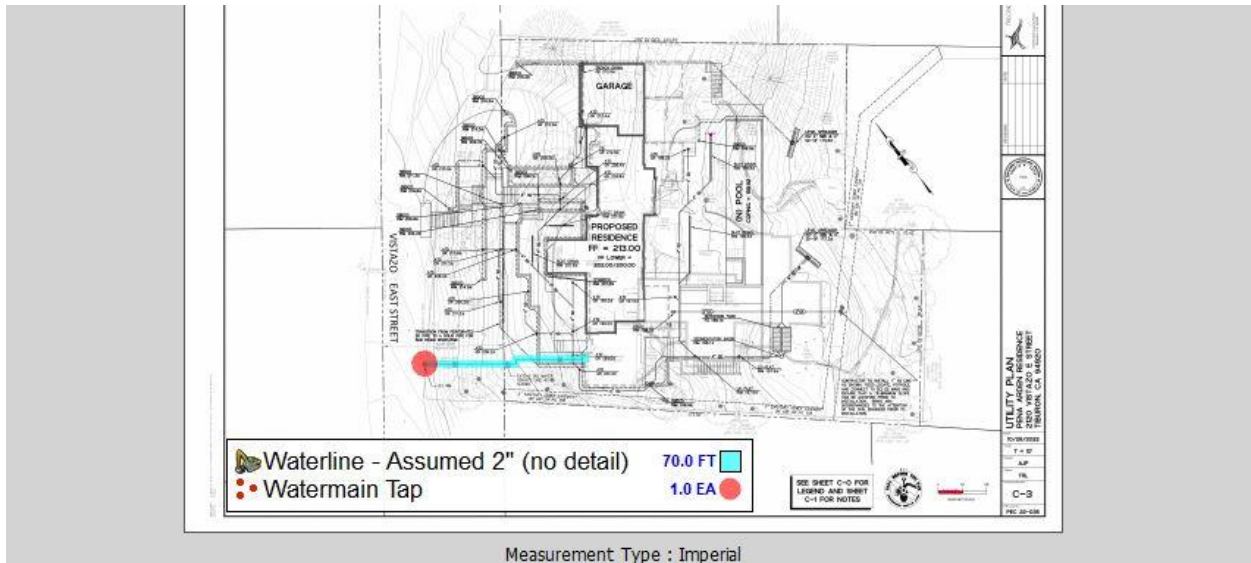

Measurement Type : Imperial

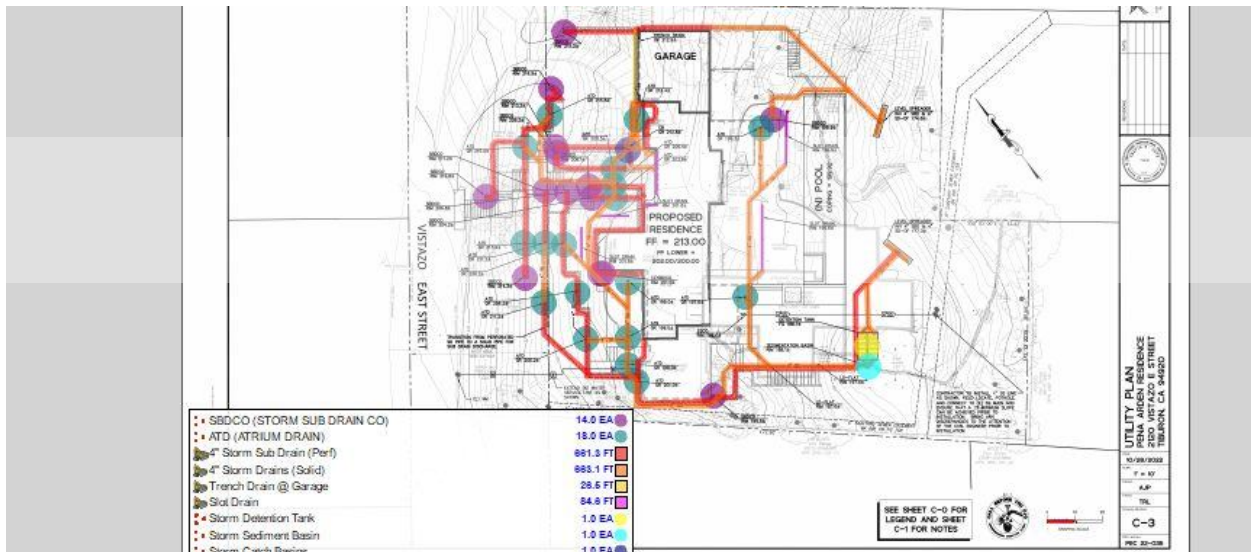

Paydirt Earthworks Support Services
contact@paydirtestimating.com
 843-900-1002
 170 Meeting Street
 Charleston, SC 29401

PENA AEDEN RESIDENCE		Description	Qty	Units	Cost Eac	Markup	'Price Eac	Price Total
Storm Sewer								
SBDCO (STORM SUB DRAIN CO)			14	EA	0	0	0	0
ATD (ATRIUM DRAIN)			18	EA	0	0	0	0
4" Storm Sub Drain (Perf) 2.00' x 4.00' Vertical Tr			661.3	FT	0	0	0	0
Excavated Volume			196	CU YC	0	0	0	0
Pipe Displaced Volume			2.14	CU YC	0	0	0	0
Native Backfill			147	CU YC	0	0	0	0
Pipe Zone Backfill			22.36	CU YC	0	0	0	0
Bedding			24.49	CU YC	0	0	0	0
4" Storm Drains (Solid) 2.00' x 4.00' Vertical Tr			663.1	FT	0	0	0	0
Excavated Volume			196.5	CU YC	0	0	0	0
Pipe Displaced Volume			2.14	CU YC	0	0	0	0
Native Backfill			147.4	CU YC	0	0	0	0
Pipe Zone Backfill			22.41	CU YC	0	0	0	0
Bedding			24.56	CU YC	0	0	0	0
Trench Drain @ Garage 1.00' x 2.00' Vertical Tr			26.45	FT	0	0	0	0
Excavated Volume			1.96	CU YC	0	0	0	0
Pipe Displaced Volume			0.08	CU YC	0	0	0	0
Native Backfill			0	CU YC	0	0	0	0
Pipe Zone Backfill			1.38	CU YC	0	0	0	0
Bedding			0.49	CU YC	0	0	0	0
Slot Drain 1.00' x 2.00' Vertical Tr			84.59	FT	0	0	0	0
Excavated Volume			6.27	CU YC	0	0	0	0
Pipe Displaced Volume			0.62	CU YC	0	0	0	0
Native Backfill			0	CU YC	0	0	0	0
Pipe Zone Backfill			4.08	CU YC	0	0	0	0
Bedding			1.57	CU YC	0	0	0	0
Storm Detention Tank			1	EA	0	0	0	0
Storm Sediment Basin			1	EA	0	0	0	0
Storm Catch Basins			1	EA	0	0	0	0
WATERLINE								
Waterline - Assumed 2" (no det) 3.00' x 5.00' Vertical Tr			70.01	FT	0	0	0	0
Excavated Volume			38.89	CU YC	0	0	0	0
Pipe Displaced Volume			0.06	CU YC	0	0	0	0
Native Backfill			31.12	CU YC	0	0	0	0
Pipe Zone Backfill			3.83	CU YC	0	0	0	0
Bedding			3.89	CU YC	0	0	0	0
Watermain Tap			1	EA	0	0	0	0
Sanitary Sewer								
Sanitary Sewer 4" 3.00' x 5.00' Vertical Tr			70.33	FT	0	0	0	0
Excavated Volume			39.07	CU YC	0	0	0	0
Pipe Displaced Volume			0.23	CU YC	0	0	0	0
Native Backfill			31.26	CU YC	0	0	0	0
Pipe Zone Backfill			3.68	CU YC	0	0	0	0
Bedding			3.91	CU YC	0	0	0	0



PAYDIRT

EARTHWORKS SUPPORT SERVICES

Pipe and Erosion Control Samples Continued

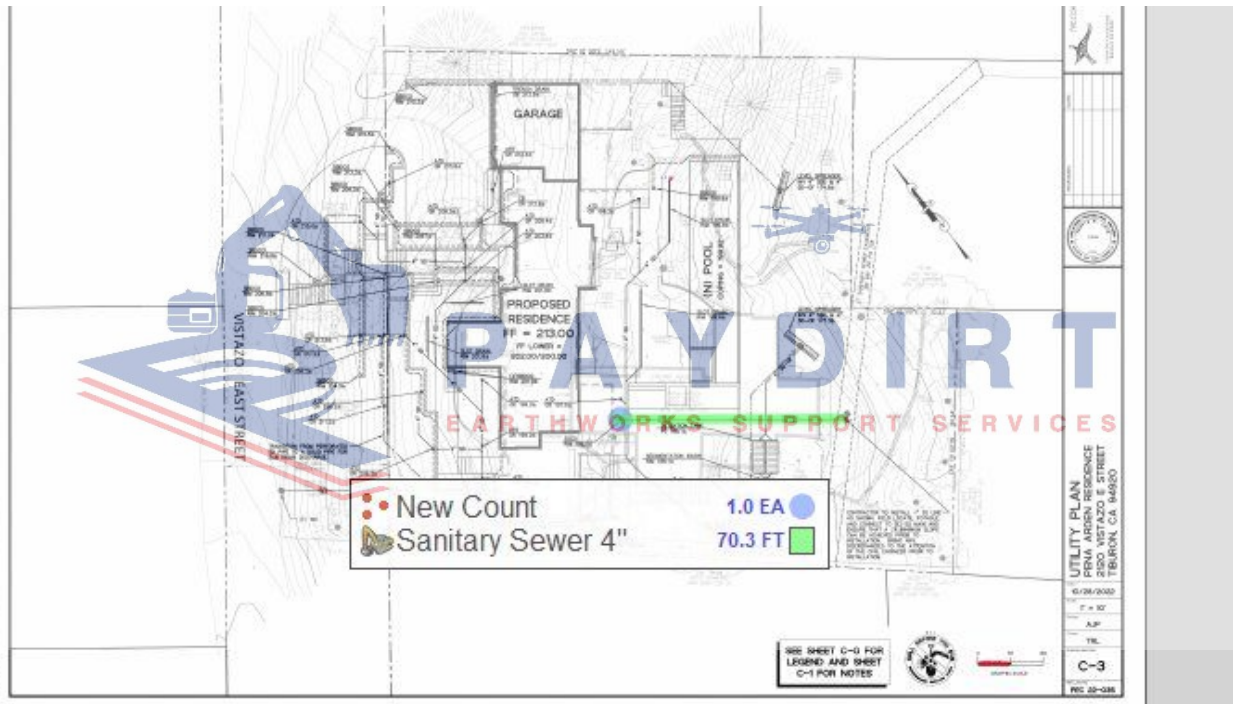

Paydirt Earthworks Support Services
contact@paydirtestimating.com
843-900-1002
170 Meeting Street
Charleston, SC 29401



PAYDIRT

EARTHWORKS SUPPORT SERVICES

Pipe and Erosion Control Samples Continued

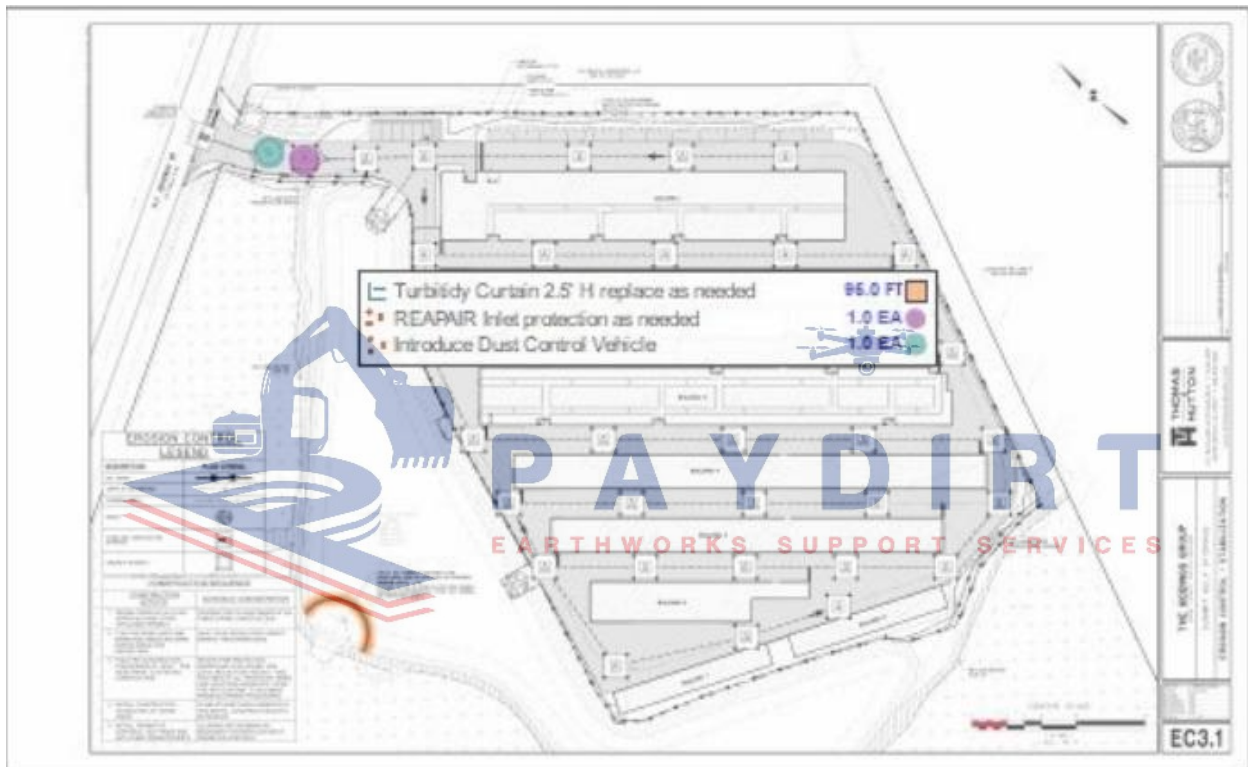

Paydirt Earthworks Support Services
contact@paydirtestimating.com
843-900-1002
170 Meeting Street
Charleston, SC 29401



PAYDIRT

EARTHWORKS SUPPORT SERVICES

Pipe and Erosion Control Samples Continued

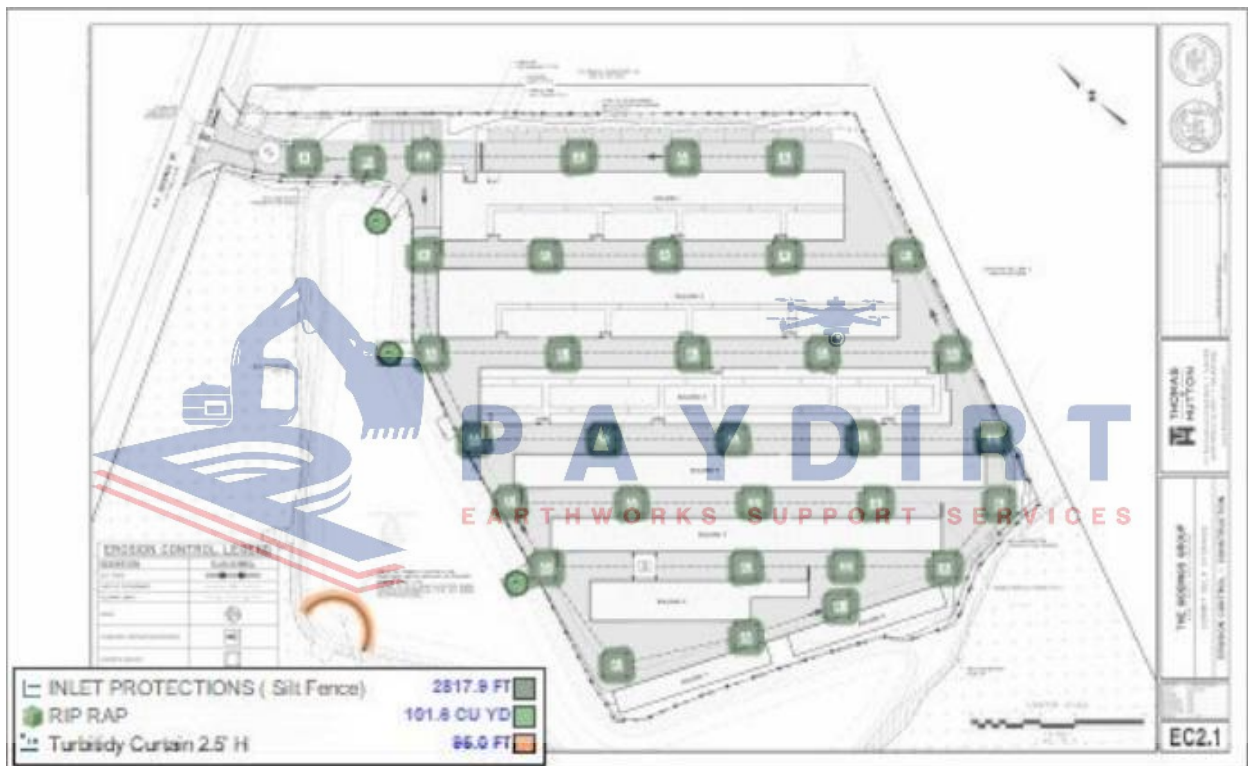

Paydirt Earthworks Support Services
contact@paydirtestimating.com
843-900-1002
170 Meeting Street
Charleston, SC 29401



PAYDIRT

EARTHWORKS SUPPORT SERVICES

Pipe and Erosion Control Samples Continued

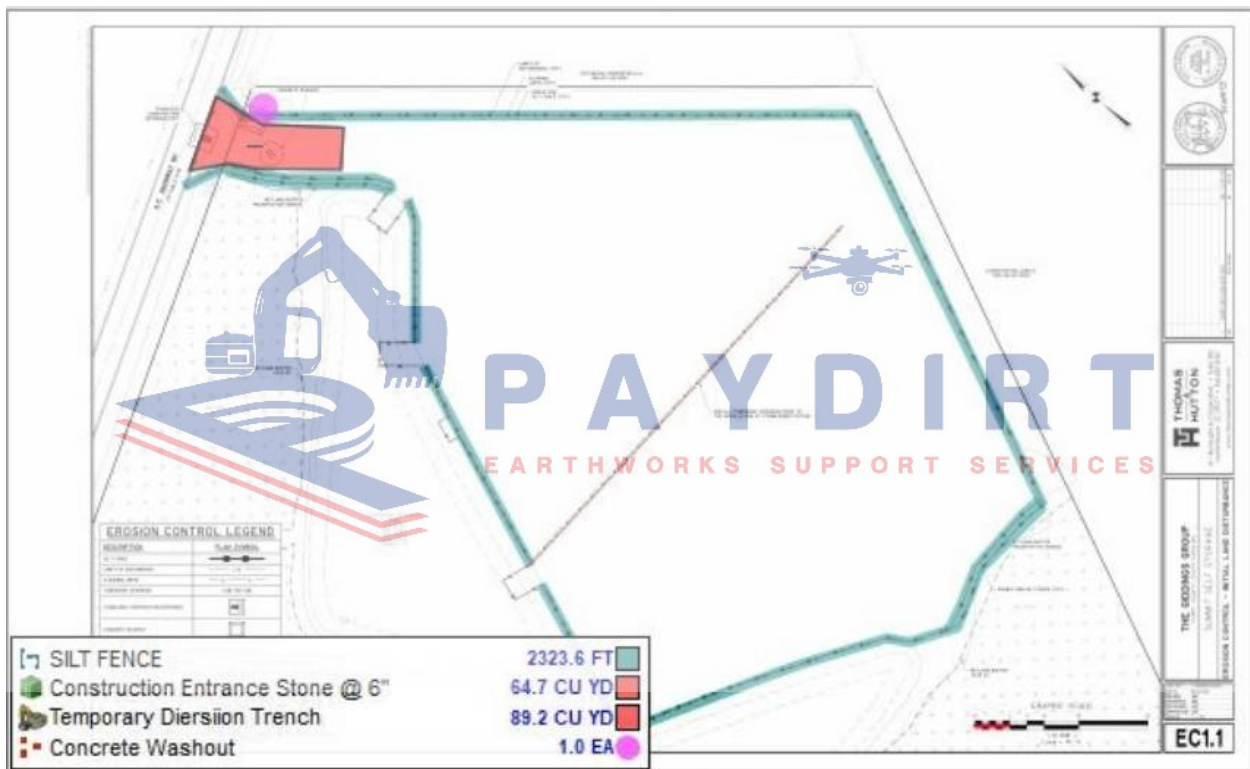

This Concludes the takeoff sample section.

Paydirt Earthworks Support Services
contact@paydirtestimating.com
 843-900-1002
 170 Meeting Street
 Charleston, SC 29401



PAYDIRT
EARTHWORKS SUPPORT SERVICES

Man Hours Estimate Sample

This is a sample of a man hours estimate. Here we will break down all of the work areas and provide an estimated man hours and machinery for your project. With this information all you have to do is add up your materials pricing and your labor pricing and put it into your bid form. The above takeoffs examples are also included with this. *This sample shows the complete price for each work order, for just a man hours estimate, it will not have any pricing.*



PAYDIRT
EARTHWORKS SUPPORT SERVICES

Paydirt Earthworks Support Services
contact@paydirtestimating.com
843-900-1002
170 Meeting Street
Charleston, SC 29401

Job:
 Customer:
 Date:

<p>EC</p> <p>Silt fence - 2,324 LF - \$11,620</p> <p>Diversion Trench - 20 D6</p> <p>Silt Fence Inlet Protection - 2,818 LF - \$14,090</p> <p>Dust Control - \$5,000 TK Rental - 80 Op charge - \$12,600</p> <p>1 Concrete W/O - \$1,500</p> <p>95' Turb curtain - 10 Lab - \$750, \$750 mat - \$1,500 Total</p> <p>Temp Entrance - 240 T - 10CTL, 10 Lab - \$2,250 - \$17,337 w/ fabric</p> <p>Rip Rap - 101 CYU - 160 T - \$12,435 - 20 CTL, 40 Lab - \$18,435 Total</p> <p>\$5,500 Mat</p> <p>Total - \$87,582</p>	<p>Notes</p> <p>Stone Haul Rate - \$7.31 P/T Export - \$5.875 P/CYU</p> <p>ABC - \$40.58 P/T 57's & Temp Stone - \$60.78 P/T RR - \$77.72 P/T Export - \$6.59 per CYU</p>
<p>Cut/Fill</p> <p>Topsoil Strip - None</p> <p>Cut - 16,223 CYU Banked, 19,468 CYU Expanded</p> <p>Export Option - 200 336 (load straight into trucks and stockpile), 50 D6 - \$62,500</p> <p>Export if needed - \$5.875 per CYU - \$120,093 (5% markup)</p> <p>Import - 18,250 CYU - \$415,500</p> <p>IF NEEDED (straight export option) - Temp roadway - 600 T of Surge/#4 - 1,700' X 20' @ 4" - \$22,747 - 30 D, 30 C - \$12,900 = \$35,647</p>	<p>Stoning</p> <p>HD Pavement - 95,163 SF @ 8" of ABC - 4,303 T - Order 4,400 T - \$178,552 - 30 Grader, 30 comp, 30 CTL -</p> <p>LD Pavement - 7,961 SF @ 6" of ABC - 268 T - Order 300 T - \$12,174 - 10 Grader, 10 Comp, 10 CTL -</p> <p>Buildings - 102,200 SF @ 6" ABC - 3,449 T - Order 4,000 T - \$162,320 - 5 H per - 8 Total - 40 Grader, 40 Comp, 40 CTL -</p> <p>Total Labor - \$42,400</p> <p>Total Stone - \$353,046</p> <p>Total: \$395,446</p>

\$633,740

Selective Cut/Fill Option: 200 336, 200

Dozer - Cut,
200 Dozer, 200 336, 200 Comp - Fill
\$236,000
Have Scraper on site - Charge 100 H -
\$30,000
Export if reused - 1,218 CYU - \$8,000 plus 20
336 - \$13,000

\$279,000 total

Stockpile

If Stockpile - 300 Haul Truck, 150 Dozer, 150
336 - \$120,000

Unload Stock Pile - 300 Haul truck, 150 336,
20 D6 - \$87,500
Fill - Subgrade Areas - 15,208 CYU Banked -
18,250 CYU Expanded - 170 Dozer, 170
Comp - \$73,100
Rentals - \$70,700
Export if reused - 1,218 CYU - \$8,000 plus 20
336 - \$13,000

Total: \$364,300

Fine Grade - 40 D6, 20 CTL - \$13,000

Water

6" C900 - 5' D - 883' - 20 336, 40 Lab, 20
CTL

6 Hydrants - 15 307.5, 30 Lab -

Valves and assemblies - 40 Lab -

Bedding - 200 T Sand

Backfill Under Pavement - 57's - 100 T

1.5" - UP - 50', Native - 214' - 264' Total
- 15 307.5, 30 Lab, 10 CTL

Bedding - 40 T Sand - \$2,431
Backfill Under Pavement - 57's - 40 T -
\$2,431

Export - 170 CYU BK. - 200 CYU Exp. - 5
336, \$1,318 Export

Lab - \$25,400

Import/Export - \$6,180

Mat - \$36,703

Bore - \$3,500

Tap - 30 Lab, 10 307.5

Sewer

6" - 315 UP - 20 307.5, 20 Lab, 20 CTL -
\$8,100

57's - 260 T - \$15,803

Export - 175 BK, 220 Exp. - \$1,550

Force Main -150' UP, 100' Native - 250' Total -
15 307.5, 30 Lab, 15 CTL - \$7,200

57's - 220 T - \$13,372

Export - 143 BK, 200 Exp - \$1,318

Storm

15" RCP @ 5' - 2,431' - 60 336, 60 CTL, 120
Lab -

18" RCP @ 7' - 615' - Bench Cut Add 5 336,
20 336, 40 Lab, 20 CTL -

24" RCP @ 8' - 85' - 7 336, 10 Lab, 5 CTL

24" RCP @ 5' - 27' - 3 336, 6 Lab, 3 CTL -

33 Structures - Avg 5' - 3 Exc, 1.5 CTL, 4.5
Lab - \$43,313



Import/Export Total - \$32,043

Labor - \$15,300

Mat - \$6,596



10 336

340 T 57 - Structures - \$20,667

Export - 245 CYU - 300 CYU - \$1,977

Labor Pipe - \$50,150

Stone Pipe - ~~2,500 T~~ - \$151,950

Stone - Structures @ 10 T Each - \$20,057

Export Pipe - 2,144 BK, 2,580 CYU Exp. - \$17,003

Total Labor - \$93,463

Mat - \$185,000



PAYDIRT
EARTHWORKS SUPPORT SERVICES

Bid Proposal - Complete Estimations

This is a sample of our bid proposal and complete estimation. This includes the man hours estimate form and all applicable takeoffs shown above. For complete bid proposals we recommend having your costs and charges for labor sent to us, if you do not know these overhead numbers Paydirt can create your overhead costs and charges for you.

All Bid Proposals - Complete Estimations come with our customizable spreadsheet tailored to your company.



PAYDIRT
EARTHWORKS SUPPORT SERVICES

Paydirt Earthworks Support Services
contact@paydirtestimating.com
843-900-1002
170 Meeting Street
Charleston, SC 29401

YOUR COMPANY LOGO HERE

PROPOSAL FOR EXCAVATION SERVICES

Date: 04/15/23

To: <Customer Name>
<Address 1>
<Address 2>
<City, State Zip>

<Customer Home Phone Number>
<Customer Mobile Phone Number>
<Customer Work Phone Number>

By: Your Company Info
Company:
Contact:
Phone:
Email:

Re: Project Information Here

OPTIONAL: Your company's mission statement here.

Scope of Work:

- Based on plans and direction from owner.

Landslide Correction - Option 1: \$137,637

- Correction of 150' L X 25' W area on hillside. Scrape of organic materials of approximately 75 CYU, import of 820 CYU of structural fill to create a 3:1 slope. Adding rip rap boulders at the bottom and 1' thick of rip rap along the whole work area, approximately 200 tons of rip rap imported. Fabric underlayment separating fill and rip rap.

YOUR COMPANY FOOTER
INFORMATION HERE

YOUR COMPANY LOGO HERE

Landslide Correction - Option 2 - Gabion Wall: \$165,000

- Correction of 150' L X 25' H area. Approximately 3,750 square feet of wall. Budgetary number, within 20% of true price.

Pavement Base Bid - Option 1: \$8,413

- Adding base and asphalt to the existing pavement area that has been washed out. Approximately 5'X20'.

Pavement Alt Bid - Option 2: \$15,716

- Adding base and asphalt to the existing pavement area that has been washed out. Approximately 110' X 3' Wide Pavement Extension. Includes rock base and asphalt .

Culvert Repairs: \$45,370

- Replacement of (1) 4'X20' culvert w/ rip rap, and (3) 60' sections (being 180' L total). Pipe is assumed to be 24" HSPE to be used. Includes import of fill dirt for washed out areas. Includes 1 headwall replacement. Approximately 675 tons of fill to be imported.

Mobilization: \$2,490

Total: TBD

Qualifications:

- Any concealed or unforeseen conditions not limited to rock formations larger than 18" in diameter, buried concrete, or buried stumps and/or roots would be considered additional work, and costs incurred will be based on time and materials.

Your Custom Qualifications Here

Your Custom Qualifications Here

Exclusions:

- Layout, permits, related fees, surveying/staking, tree removal, lot clearing/grubbing, underpinning, compaction testing, final grading, etc.

**YOUR COMPANY FOOTER
INFORMATION HERE**

YOUR COMPANY LOGO HERE

Your Custom Exclusions Here

Your Custom Exclusions Here



Your Custom Exclusions Here

Your Custom Exclusions Here

Your Custom Exclusions Here

Your Custom Exclusions Here

Your Custom Exclusions Here

YOUR COMPANY FOOTER
INFORMATION HERE

YOUR COMPANY LOGO HERE

Client agrees as follows: The client further agrees not to engage any employee or Sub-Contractors to do any independent work "side jobs" without the express written permission of

NOTE: This proposal may be withdrawn by us if not accepted within (5) days.

Authorized Signature: Date _____.

Acceptance of Contract: The above prices, specifications, and conditions are satisfactory and are hereby accepted as evidenced by my signature below and by my signature on the last page of the proposal. Payment will be made as outlined above.

Authorized Signature: _____
_____ **Date**

CLIENT NAME TO SIGN HERE

Authorized Signature: _____
_____ **Date**

CLIENT NAME TO SIGN HERE

**YOUR COMPANY FOOTER
INFORMATION HERE**



PAYDIRT

EARTHWORKS SUPPORT SERVICES

Detailed Reports

For mass grading, utilities, and other complex jobs we can make a detailed report on the best way to grade and install underground utilities. This is needed for some projects, primarily mass grading and mass underground works to figure the most cost efficient way to perform a job. This is also offered for smaller projects to help with job schedules and deadlines.

Paydirt Earthworks Support Services
contact@paydirtestimating.com
843-900-1002
170 Meeting Street
Charleston, SC 29401

Monolith - Sovereign

Detailed Cut Fill

04/17/22

Cut/Fill

Topsoil Strip: 40,778 Banked CYU

Cut: 991 Banked CYU (pond)

Total Cut: 41,779 Banked CYU

Total Cut Hauled w/ Haul Trucks: 51,559 Expanded

Total w/ no Haul Trucks: 7,407 Banked, 11,111 Expanded

From Wet Areas Expanded - 62,670 CYU Export Approximate After Drying - 56,401 CYU

(2) 10,000 SF Soil Dry Areas, one on North side, one on South side @ 6' - 2,222 CYU Capacity
Each 4,444 CYU Total

OR

(1) 50,000 SF Soil Dry Area @ 6' 11,111

Approximately 1,000 LF of matting if 1 exc, 1,400 LF of matting needed if 2 exc being used

1 exc and 2 haul truck production approximately 300' one way trip - 600' R/T - approximately 880' per minute @ 10 MPH,

Round Trip Time - 5 minutes driving, 2 minute dump time, 5.5 minute load time 336 Cat or similar sized machine w/ 2.5 CYU bucket. 10 cycles per truck, cycle time @ 33 second per cycle.

12.5 minute truck cycle time @ 25 CYU per load

120 CYU per truck per hour

336 - Cycle Rate @ 272.5 CYU P/H - Can Keep up w/ 2 trucks

2,400 CYU Daily Rate @ 10 Hour Days

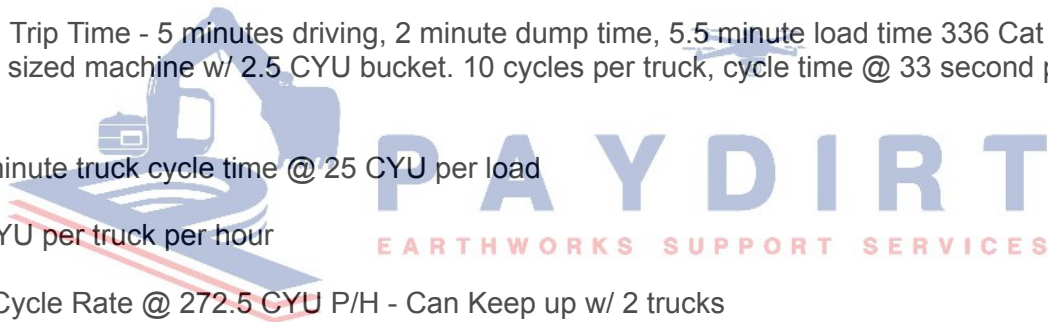

Monolith - Sovereign

Detailed Cut Fill

04/17/22

CUT

W/O Haul Trucks - 11,111 CYU: 50 336 Hours

W/ Haul Trucks - 51,559 CYU : 215 336, 430 Haul Trucks

Mound: 215 D6 or D7

Total Cut Hours: 265H - 336, 430H Haul Trucks, 215H - D6/D7

Fill

Fill: 95,655 CYU Expanded, 70,855 CYU Compacted - ALL IMPORT -18" Lifts, wait to settle, fab laying between unsuitable soil and new subgrade.

*Fill in quadrants (progressive cut/fill), cut site into 4 sections, do 1 quadrant @ 18" lift and go to the next quadrant, this will allow areas to dry out and rotate. This will allow smaller crews to work continuously w/o multiple mobilizations.

263,900 SF site, each quadrant being 65,975 SF. - 4,948 CYU Per 18" in each Quadrant - 5 lifts approx needed.

Per Lift, per quadrant: 50 D6/D7, 50 Comp PER

Total Fill Hours: 1,000 D6/D7, 1,000 Comp Hours

Import/Export

Import - 95,655 CYU

Export - 56,401 CYU - 336 Cycle @ 30 second per - 300 CYU per hour - 190 336 Hours



Grid/Subgrid	3.00/1.50		
Section size (Ft)	985.82 x 643.01		
Total Work Area (SF)	216,180	Cut Area Threshold 0.01 Ft	Fill Area Threshold 0.01 Ft
Area of Cut (SF)	179,352		
Area of Fill (SF)	36,648		

All units in Cubic Yards











	Bank	Compacted	Expanded	Comp / Exp (%)
Stripping				
Top Soil				20 / 25
Brown Lean Clay				5 / 35
Brown Clayey Sand				5 / 35
Brown Fine Medium Sand				10 / 10
Limestone				-5 / 35
Stripping Total				
Export Stripping				











Cut				
Top Soil	4,603	3,683	5,754	20 / 25
Brown Lean Clay	16,868	16,025	22,772	5 / 35
Brown Clayey Sand	2,152	2,044	2,905	5 / 35
Brown Fine Medium Sand	20,255	18,230	22,281	10 / 10
Limestone	23,107	24,262	31,194	-5 / 35
Cut Total	66,986	64,244	84,907	
Export Cut		60,955	80,679	
Total Export (Stripping and Cut)		60,955	80,679	

Fill				
In Place Fill Required		3,289		
Stripping and/or Cut Used as Fill	3,132	3,289	4,229	
Import Fill				

Topsoil Replacement				
Topsoil Replacement Required				
Topsoil Replacement Obtained On Site				
Import Topsoil				



#	Desc	Type	Value	Area (SF)	Fill (CY)	Cut (CY)	Bank	Compacted	Expanded	Chg/.1 Ft
▶ 1	 Topsoil	DPT	0.5	58,080	2,320		7,775	7,347	9,843	215
▶ 3	 Sidewalk	DPT	0.77	7,530	117		1,252	1,171	1,592	28
▶ 5	 SD Asphalt	DPT	1.16	52,508	444		13,249	12,481	16,632	194
▶ 6	 Building 1	EL	1030.08	25,915	0		14,738	14,281	18,632	96
▶ 7	 Building 2	EL	1032.02	27,304	0		12,965	12,367	16,281	101
▶ 8	 Building 3	EL	1021.08	26,256	0		13,896	13,716	18,046	97
▶ 9	 Topsoil	DPT	0.5	9,048	71		2,238	2,081	2,765	34
▶ 10	 Clubhouse	EL	1040.08	2,266	0		466	431	606	8
▶ 11	 Pool Deck	EL	1044.25	4,914	336		68	60	88	18
▶ 12	 Pavers	DPT	0.75	261	0		22	20	29	1
▶ 13	 Sidewalk	DPT	0.77	2,199	2		319	290	395	8
▶ All				216,280	3,289		66,986	64,245	84,907	801

#	Desc	Type	Value	Area (SF)	Material	THK (Ft)	CY
▶ 1	 Topsoil	DPT	0.5	58,080	Topsoil	.50	1,076
▶ 3	 Sidewalk	DPT	0.77	7,530	DGB Concrete	.35 .42	98 117
▶ 5	 SD Asphalt	DPT	1.16	52,508	Asphalt DGB	.33 .83	642 1,614
▶ 6	 Building 1	EL	1030.08	25,915	Engineered Fill Concrete	3.75 .67	3,599 643
▶ 7	 Building 2	EL	1032.02	27,304	Engineered Concrete 57's	3.75 .67 .50	3,792 678 506
▶ 8	 Building 3	EL	1021.08	26,256	Engineered Concrete 57's	3.75 .67 .50	3,647 652 486
▶ 9	 Topsoil	DPT	0.5	9,048	Topsoil	.50	168
▶ 10	 Clubhouse	EL	1040.08	2,266	Engineered Concrete 57's	3.75 .67 .50	315 56 42
▶ 11	 Pool Deck	EL	1044.25	4,914	DGB Concrete	.33 .42	60 76
▶ 12	 Pavers	DPT	0.75	261	DGB Concrete	.33 .42	3 4
▶ 13	 Sidewalk	DPT	0.77	2,199	DGB Concrete	.35 .42	29 34

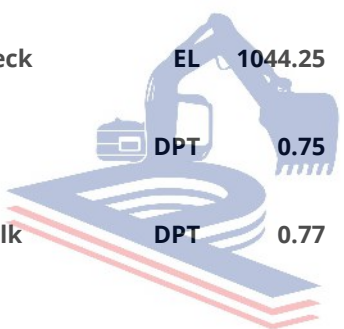
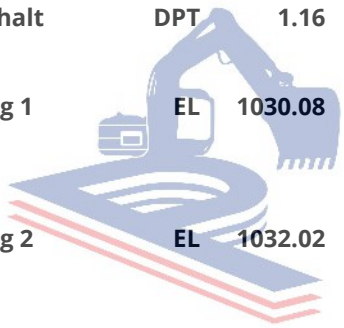



	Material Totals	CY
	57's	1,514
	Asphalt	642
	Concrete	2,260
	DGB	1,803
	Engineered	7,754
	Engineered Fill	3,599
	Topsoil	1,243

WORK ELEMENT - STORM	LABOR										TRUCKING								MATERIALS						
	Crew Type	Task Drop down	Size	Units of work	Hours	Hourly Production	Variation	Cost	Charge	Truck Type	Import/Export	Cost after Tax per unit	Material type	Unit of Meas.	Capacity	R/T Haul Rate	Unit Cost	SUBTOTAL	DESCRIPTION	APPLICATION	UNIT of Measure	UNITS RATE	Tax Rate	SUBTOTAL	TOTAL
Example	A1, A2	RCP	18"	1000	F, G, H, I = Total	20	0.90			Tri-Axle	Import	\$ 10.00	Fill Sand	Ton	15	1									
Administrative																									
Move-In																									
Move-Out																									
Excavation for																									
Interior Footers																									
Interior Slab & Footer Prep																									
Pour Interior Slab & Sidewalk																									

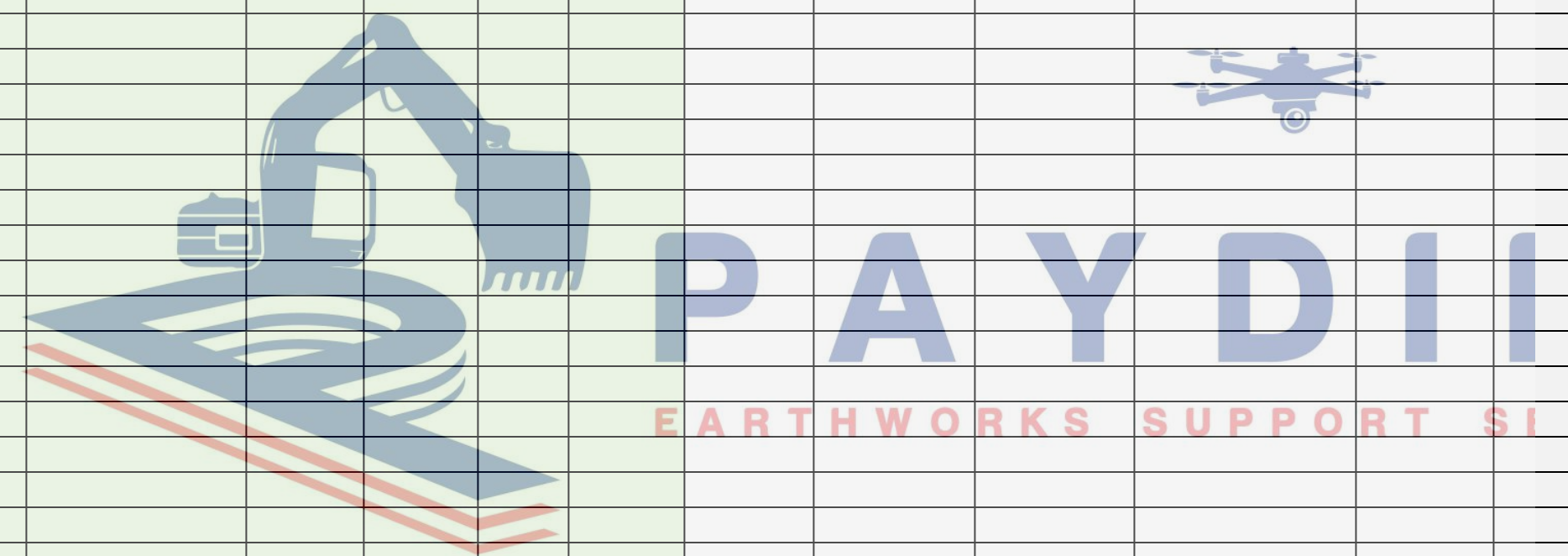

New Format																				
Applicable to	Pipe Type	Description	Sizes	Sizes	Sizes	Sizes	Sizes	Sizes	Sizes	Sizes	Sizes	Sizes	Sizes	Sizes	Sizes	Sizes	Sizes	Sizes	Sizes	Sizes
Storm	RCP	Reinforced Concrete	6	8	12	15	18	24	30	36	42	48	54	60	72	84	96	108	120	
Storm	HP	High Performance	4	6	8	12	15	18	24	30	36	42	48	54	60	72	84	96	108	120
Storm	HDPE - SW	High Density Poly	4	6	8	12	15	18	24	30	36	42	48	54	60	72	84	96	108	120
Storm	HDPE - DW	High Density Poly	4	6	8	12	15	18	24	30	36	42	48	54	60	72	84	96	108	120
Storm	CMP	Corrugated Metal	4	6	8	12	15	18	24	30	36	42	48	54	60	72	84	96	108	120
Storm	Corrugated Tile	rolled up, cheap st	4	6	8															
Storm, Sewer	SDR 35	Thin walled green	4	6	8	12	15	18	24	30	36									
Storm, Sewer	SDR 26	Thicker walled Gre	4	6	8	12	15	18	24											
Storm, Sewer	SCH 40	PVC	4	6	8	12	15	18	24											
Water, Sewer	HDPE - High Press	Different than the	1	2	3	4	5	5	8	10	12	15	18	24	30	36				
Water, Sewer	DIP	Ductile Iron Pipe, t	4	6	8	12	15	18	24											
Water, Sewer	C900	Typically used for v	4	6	8	12	15	18	24											
Water	SDR 9	Coiled up usually, t	0.5	0.75	1	1.25	1.5	1.75	2	2.5	3									
Water	SDR 21	Same as SDR 9, jus	0.5	0.75	1	1.25	1.5	1.75	2	2.5	3									
Water	Type-K Copper	Rolled copper line	0.5	0.75	1	1.25	1.5	2	2.5	3										

Additional Items for Utilities			
Application	Item	Cost	Measurement
Water	Hydrants		Unit
Water, Sewer	Gate Valve - GV		Unit
Water	Meter Pit		Unit
Water	Yard Hydrant		Unit
Water	Meter Vault		Unit
Water	Curb Stop (CS)		Unit
Water	Back Flow Prevent		Unit
Water	Meter Vault		Unit
Sewer	Force Main		Unit

Additional Items for Utilities			
Application	Item	Cost	Measurement
Storm	Curb Inlet (CI)		Unit
Storm	Drain Inlet (DI)		Unit
Storm, Sewer	Manhole (MH)		Unit
Storm	Catch Basin (CB)		Unit
Storm	Outfall Control Str		Unit
Storm	Flare		Unit
Storm	Trench Drain		Unit
Storm, Sewer	Cleanout (CO)		Unit
Sewer	Grease Trap		Unit
Storm	Water Quality Unit		Unit

Erosion Control			
Application	Item	Cost	Measurement
EC	Seed and Straw		SF
EC	Mulching		Square Feet
EC	Hydroseed		Square Feet
EC	Silt Fence SR - Sing		Linear Feet
EC	Silt Fence DR - Dou		Linear Feet
EC	Baffles		Linear Feet
EC	Skimmer		Per Unit
EC	Rip Rap		Square Feet/CYU
EC	Inlet Protector - Tu		Unit
EC	Inlet Protect - Sack		Unit
EC	Inlet Protector - Rc		Unit

Erosion Control			
Application	Item	Cost	Measurement
EC	Diversion Ditch		SF
EC	Temp Entrance		SF/CYU
EC	Check Dam		SF/CYU
EC	Tree Protection Fe		Linear Feet
EC	Dust Control		SF
EC	Straw Log		LF
EC, Storm	Headwall		Per Unit

Import/Export			
Application	Item	Cost	Measurement
All	3/4" Drainage Stor		Ton
All	Crusher Run		Ton
All	#2/3 Clean		Ton
All	Fill Sand		Ton
All	Structural Fill		Ton/CYU
All	Reg. Fill		Ton/CYU
All	Topsoil		Ton/CYU
All	Pea Gravel		Ton
All	Rip Rap		Ton

Import/Export			
Application	Item	Cost	Measurement
All	3/4" Drainage Stor		Ton
All	Crusher Run		Ton
All	#2/3 Clean		Ton
All	Fill Sand		Ton
All	Structural Fill		Ton/CYU
All	Reg. Fill		Ton/CYU
All	Topsoil		Ton/CYU
All	Pea Gravel		Ton
All	Rip Rap		Ton

Import/Export			
Application	Item	Cost	Measurement
All	3/4" Drainage Stor		Ton
All	Crusher Run		Ton
All	#2/3 Clean		Ton
All	Fill Sand		Ton
All	Structural Fill		Ton/CYU
All	Reg. Fill		Ton/CYU
All	Topsoil		Ton/CYU
All	Pea Gravel		Ton

Work Area - Main					
Sub Categories for Work Area	Water	Sewer	Standard	Standard	EC (Erosion Contro
Grading	Subgrades	Storm	Water	Sewer	EC (Erosion Contro
Cut	HD Asphalt	Culvert	Standard	Standard	
Fill	SD Asphalt	Standard	Under Pavement	Under Pavement	
Topsoil Scrape	LD Asphalt	Under Pavement			
Grubbing	Parking Pad				
	Gravel Lot				
	HD Concrete				
	SD Concrete				
	LD Concrete				
	Permeable Pavemr				

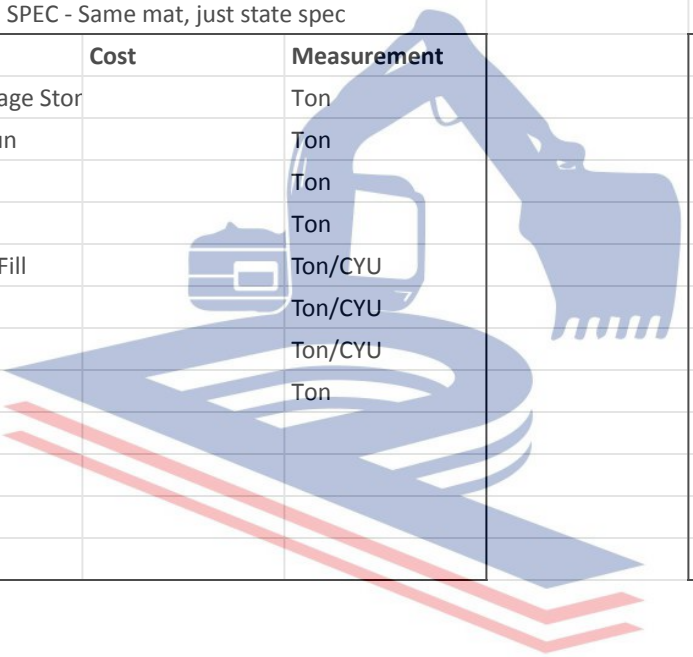

PAYDIRT
EARTHWORKS SUPPORT SERVICES